

# FCR

## Position limit switch

### Position limit switch

The **FCR position limit switch** is used to control several handling systems:

- **Bridge cranes:** the limit switch controls the operating system, for example a PLC, and allows the bridge crane to slow down or stop.
- **Hoists:** the limit switch is used to stop the hoist whenever it reaches a limit position.

### Features

- Designed to guarantee excellent performance in the most challenging operating conditions.
- Arranged with 4 fixing holes.
- Positive opening NC contacts for safety functions.
- IP65 protection degree.
- Aluminium rods with 6x6 mm section and enclosure in thermoplastic material.
- Cross rods with 4 maintained positions every 90°.
- Arranged with 1 output for cable clamps to reduce installation time and make wiring easier.
- Available different versions, also customizable on request.

### Compliance and certifications

- 2014/35/UE - 2011/65/UE - 2015/863/UE
- EN 60947-1 (2007/A1 : 2011/A2 : 2014)
- EN 60947-3 (2009/A1 : 2012/A2 : 2015)
- EN 60204-1 (2006/A1 : 2009)
- EN 60529 (1991/A1 : 2000/A2 : 2013)
- EN 50581 (2012)
- IEC 63000 (2016)

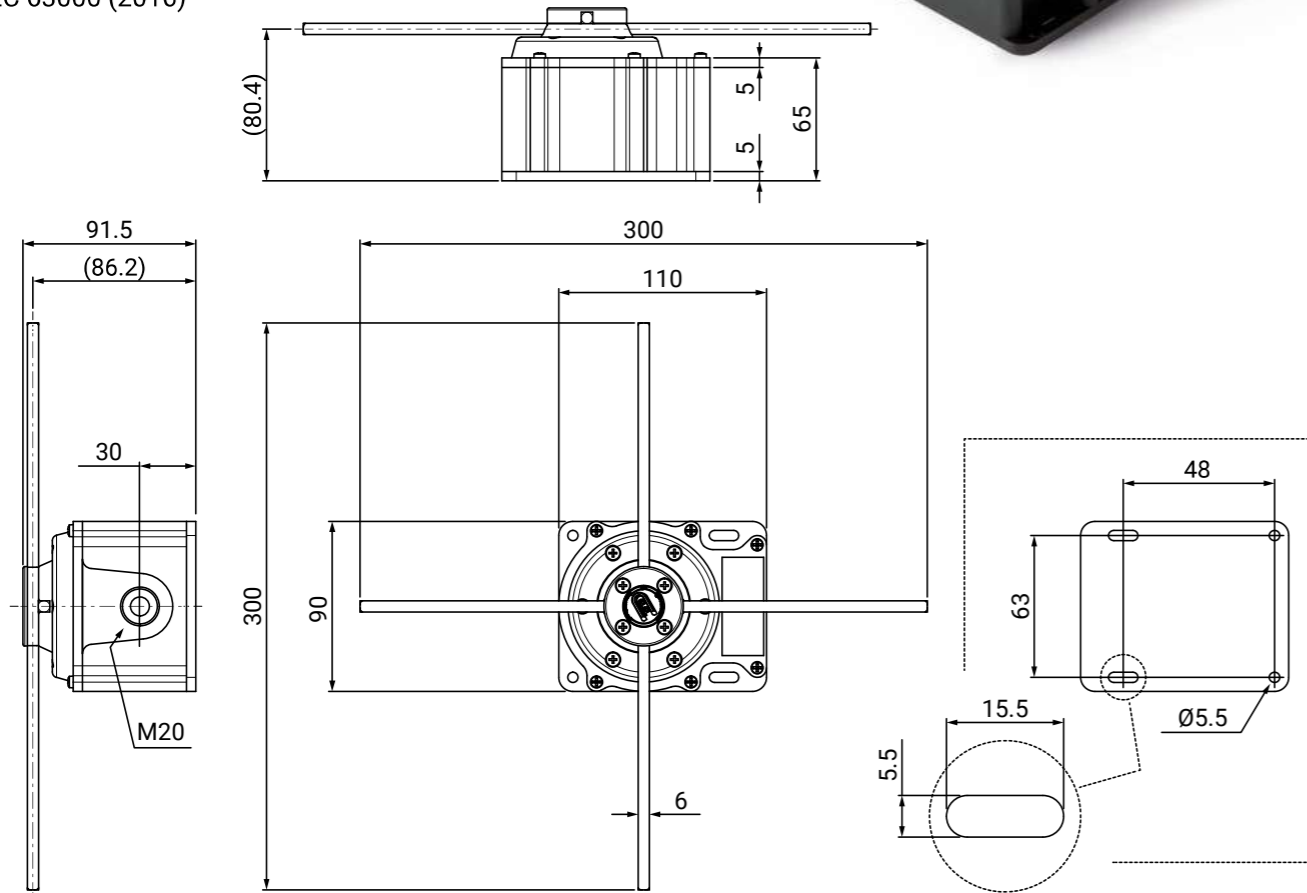
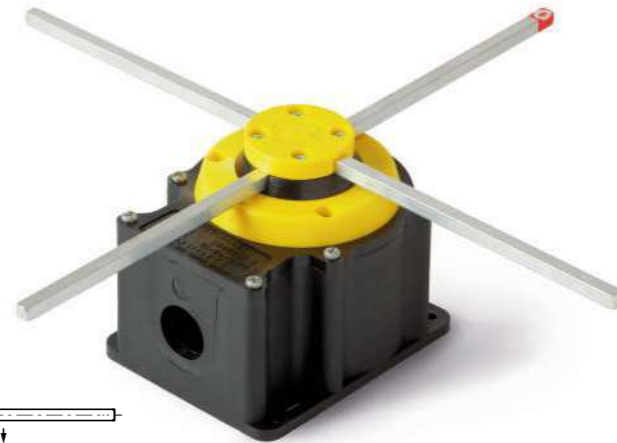

**FCR**  
Internal  
cam switch  
**P016 line**



 contact open  contact close

### Available codes

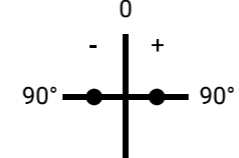
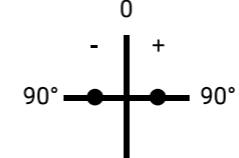
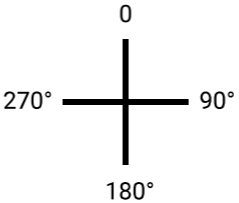
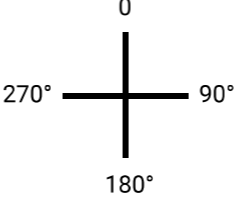
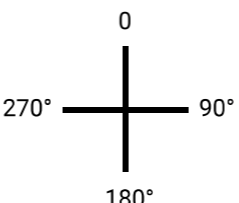
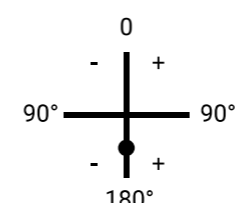
	<p><b>FCR001</b></p> <p>Single speed</p> <p>3 positions</p> <p>With mechanical interlock ●</p>	<p>contacts</p> <table border="1"> <tr> <td>3-4</td> <td></td> <td></td> <td></td> </tr> <tr> <td>1-2</td> <td></td> <td></td> <td></td> </tr> </table> <p>-90° 0 +90° positions</p>	3-4				1-2																			
3-4																										
1-2																										
	<p><b>FCR002</b></p> <p>Single speed</p> <p>3 positions</p> <p>With mechanical interlock ●</p>	<p>contacts</p> <table border="1"> <tr> <td>7-8</td> <td></td> <td></td> <td></td> </tr> <tr> <td>5-6</td> <td></td> <td></td> <td></td> </tr> <tr> <td>3-4</td> <td></td> <td></td> <td></td> </tr> <tr> <td>1-2</td> <td></td> <td></td> <td></td> </tr> </table> <p>-90° 0 +90° positions</p>	7-8				5-6				3-4				1-2											
7-8																										
5-6																										
3-4																										
1-2																										
	<p><b>FCR003</b></p> <p>Single speed</p> <p>4 positions</p> <p>Without mechanical interlock</p>	<p>contacts</p> <table border="1"> <tr> <td>3-4</td> <td></td> <td></td> <td></td> <td></td> </tr> <tr> <td>1-2</td> <td></td> <td></td> <td></td> <td></td> </tr> </table> <p>0 90° 180° 270° positions</p>	3-4					1-2																		
3-4																										
1-2																										
	<p><b>FCR004</b></p> <p>Single speed</p> <p>4 positions</p> <p>Without mechanical interlock</p>	<p>contacts</p> <table border="1"> <tr> <td>-</td> <td colspan="4">empty</td> </tr> <tr> <td>5-6</td> <td></td> <td></td> <td></td> <td></td> </tr> <tr> <td>-</td> <td colspan="4">empty</td> </tr> <tr> <td>1-2</td> <td></td> <td></td> <td></td> <td></td> </tr> </table> <p>0 90° 180° 270° positions</p>	-	empty				5-6					-	empty				1-2								
-	empty																									
5-6																										
-	empty																									
1-2																										
	<p><b>FCR005</b></p> <p>Single speed</p> <p>4 positions</p> <p>Without mechanical interlock</p>	<p>contacts</p> <table border="1"> <tr> <td>-</td> <td colspan="4">empty</td> </tr> <tr> <td>5-6</td> <td></td> <td></td> <td></td> <td></td> </tr> <tr> <td>-</td> <td colspan="4">empty</td> </tr> <tr> <td>1-2</td> <td></td> <td></td> <td></td> <td></td> </tr> </table> <p>0 90° 180° 270° positions</p>	-	empty				5-6					-	empty				1-2								
-	empty																									
5-6																										
-	empty																									
1-2																										
	<p><b>FCR006</b></p> <p>Double speed</p> <p>4 positions</p> <p>With mechanical interlock ●</p>	<p>contacts</p> <table border="1"> <tr> <td>7-8</td> <td></td> <td></td> <td></td> <td></td> <td></td> </tr> <tr> <td>5-6</td> <td></td> <td></td> <td></td> <td></td> <td></td> </tr> <tr> <td>3-4</td> <td></td> <td></td> <td></td> <td></td> <td></td> </tr> <tr> <td>1-2</td> <td></td> <td></td> <td></td> <td></td> <td></td> </tr> </table> <p>-180° -90° 0 +90° +180° positions</p>	7-8						5-6						3-4						1-2					
7-8																										
5-6																										
3-4																										
1-2																										

POSITION LIMIT SWITCHES